

les fonctions électriques

Duffay®

electrical functions - Duffay®

By producing elements in their final configuration, delivering these elements machined, pre-equipped and pre-wired, we are contributing to the continuity of the "clean concept". This enables electrical function connection to be managed outside of the clean zone.

"On-line" digital recessing, either total or partial of embedded electrical functions in the factory ensures cleanliness and the respect of the time limits imposed for installation on site. Associated with the European patent n° 92 401 132 3, we provide tight and flush electrical functions for factories.

Digital machining on aluminium and laminated facings.

Equipment

Door contact

APR 12/12C

HO5VVF 2 x 0,752

SADSEC

Equipment

Push button

LEGRAND 76424

HO5VVF 2 x 0,752

SADSEC

Equipment

Power point

ARNOULD 48300

LEGRAND 89162

RO2V

SADSEC

Equipment

Telephone / computer

plug door

ARNOULD 48310

LEGRAND 89162

SADSEC

Equipment

Voyant porte

ORBITEC E10

LEGRAND

89837

SADSEC



Equipment

Telephony

Intercoms

SADSEC



SADSEC

European patent

n° 92 401 132 3

The element could consist, for example, of a control switch or various switchgear, a coloured indicator in accordance with a colour-code, or with written markings.



The reasons for this choice

- 1 cleanliness of site
- 2 air-tightness and flush surfaces
- 3 quick to use
- 4 simplified interfacing
- 5 high quality of digital machining



11

LSB®

fonctions électriques

dessins techniques

electrical functions - technical drawings

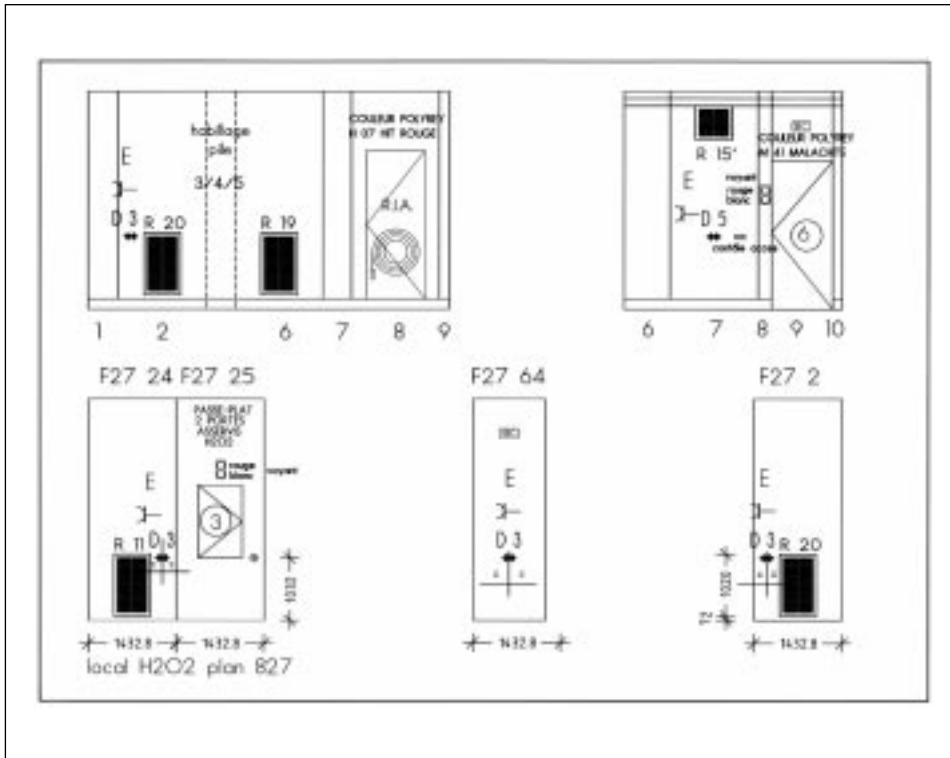

Panel allowances: QAP procedure/digital machining

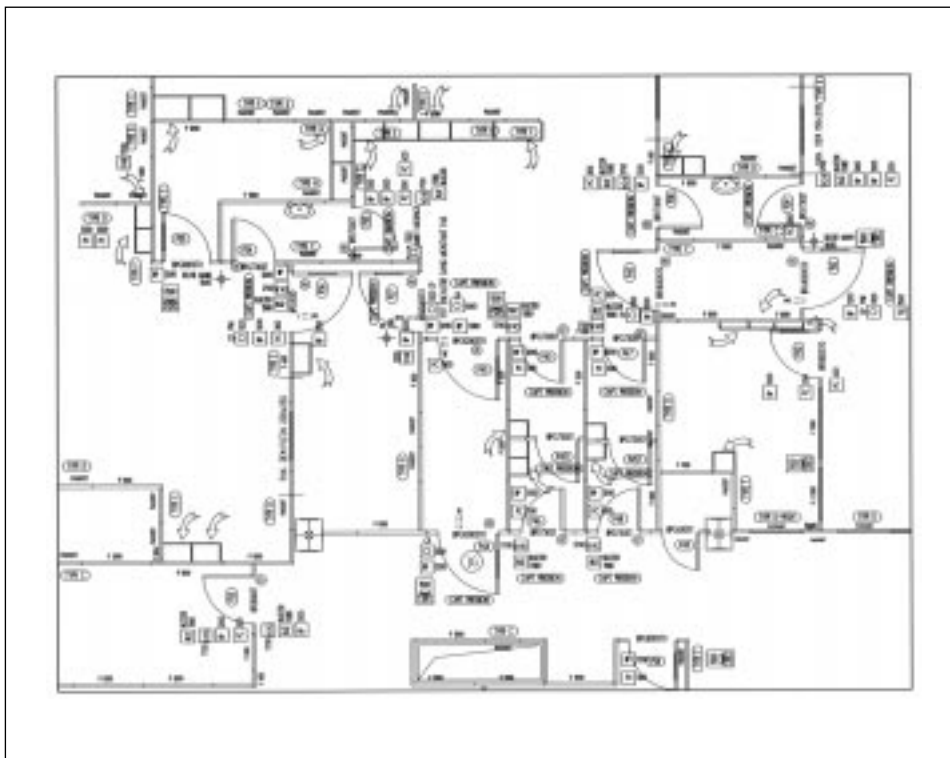

Symbols

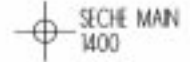
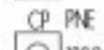

RN 100, 84400 Apt, France
 Tél. 33/0 4 90 04 71 41, Fax 33/0 4 90 04 74 47
 E-mail lsb-apt@avignon.pacwan.net, web <http://www.lasalleblanche.com>
 RC Avignon 326 676 681 83 B 73 - Code APE 361 G

